

# AIRTHEREAL Ozone Generator User Manual

 [manuals.plus/airthereal/ozone-generator-manual](https://manuals.plus/airthereal/ozone-generator-manual)

June 4, 2021



## AIRTHEREAL MA10K-PRO OZONE GENERATOR USER MANUAL

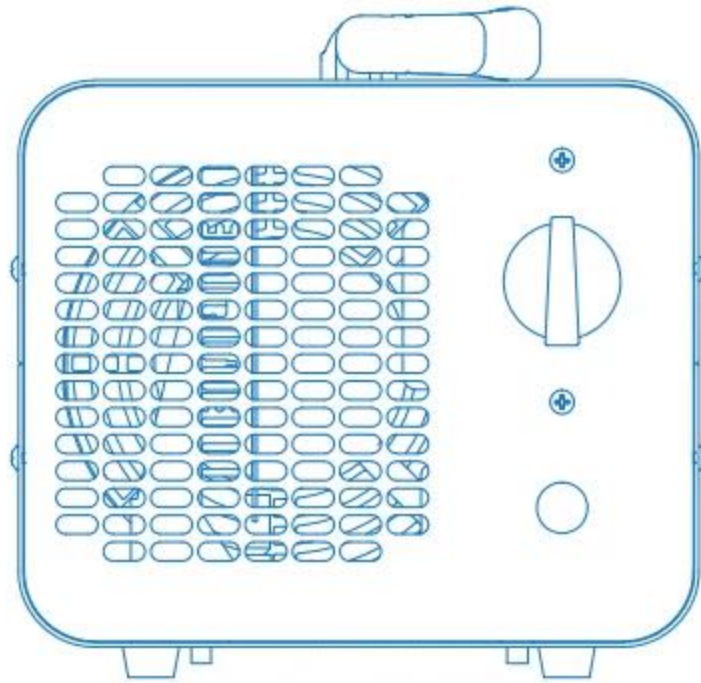

## **INTRODUCTION**

Congratulations on your purchase and welcome to Airthereal! To fully benefit from the support that Airthereal offers, register at [www.airthereal.com](http://www.airthereal.com).

## **IMPORTANT SAFEGUARDS**

**READ ALL INSTRUCTIONS BEFORE USE AND KEEP THEM FOR FUTURE REFERENCE.**

When using electrical products, especially when children are present, basic safety precautions should always be followed, including the following:

### **DANGERS**

1. Do not place or store the charger where it can fall or be pulled into a tub or sink, or where it will sit or drop into water or other liquids.
2. Do not reach for a charger that has fallen into water. Unplug immediately.
3. Never use a charger with a damaged cord or plug.
4. Keep the cord away from heated surfaces.
5. Children should be supervised to ensure that they do not play with the product.
6. Never force the plug into an outlet; if the plug does not easily fit into the outlet, do not use this outlet.

### **WARNINGS**

1. **Never use the product when humans or pets are around.**

- 2. Exposed to high concentration of ozone will be harmful. Make sure all ozone is reverted back to oxygen before you enter the space, which takes approximately 30 minutes.
- 3. Do not use attachments other than those recommended by the manufacturer.
- 4. Do not insert objects into the air filter or block it by placing it on a soft surface or in a position where they will be blocked by objects (examples of objects: magazine, tissue paper, hair, and the similar).
- 5. Use this product only for its intended use as described in this document or as recommended by Airthereal.
- 6. This product is for indoor use only.

FRONT

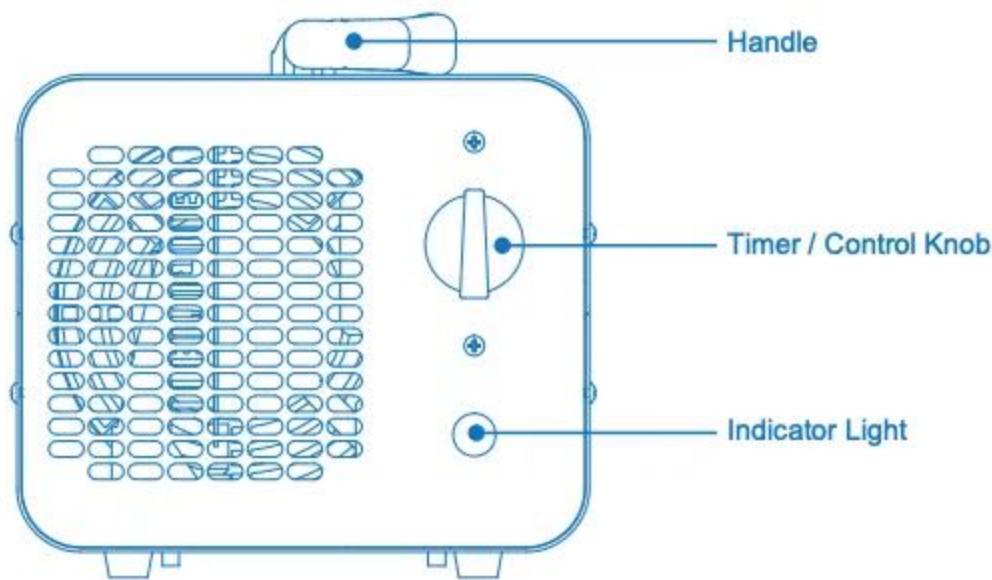

PART	DESCRIPTION
Power Knob / Timer	Switch to power on/off; Turn clockwise to set timer; Turn anticlockwise to 'hold' to keep operating.
HOLD Function	Keep operating all the time.
Indicator Light	The light will be on when the unit is in operation.

BACK

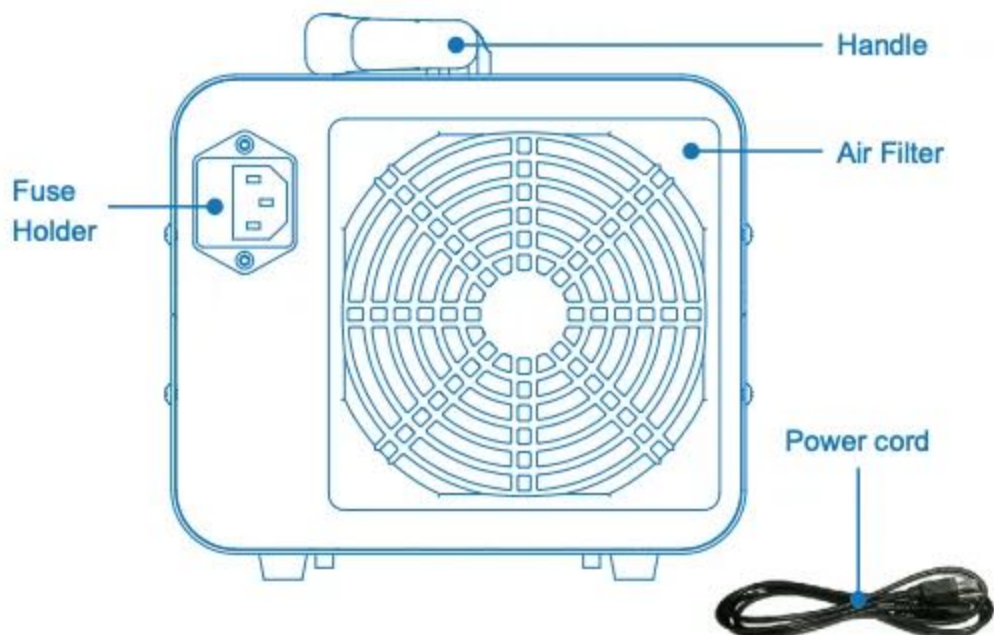

Power Supply      AC 110V / 60Hz. (for USA and Canada),  
                              18AWG, 63"(150cm) Cord  
                              AC 220V / 50Hz. (for European Union),  
                              3G\*0.75mm<sup>2</sup>, 63"(150cm) Cord

Power Consumption    110W

Ozone Production      10000mg/h

Air Flow Volume        120CFM

Noise                      < 45dB

Timer                      0-120 minutes

Unit Dimensions        9.3" \* 7.1" \* 6.8" (237\*180\*175mm )

Unit Weight             6.6lbs / 3kg

Fuse Holder              Spare fuse included, 2\*4 amp (1.25" / 31mm).

## GETTING STARTED

### 1. Set-up

- Place the unit in the room.
- Insert the power plug into a live outlet.
- Switch the power knob.

## 2. Modes

- Off: Power off.
- Timer: Turn clockwise to set timer up to 120 minutes. The unit will be automatically off when the time on the timer is reached.
- Hold: Turn anticlockwise to 'HOLD' to keep operating. Return the knob to 'OFF' model when the treatment is finished.

## 3. Treatment Reference

- Duration

Model No.	200sqft	300sqft	500sqft	700sqft	1000sqft	1500sqft	2000sqft
MA10K-PRO	10min	15min	30min	45min	60min	90min	Hold

- Frequency  
Depends on your needs. At least once a week to keep fresh air indoors.

### **ATTENTION:**

Use in unoccupied space only!

There might be ozone smell remaining in the room after treatment. Open doors and windows to ventilate for at least 30 minutes after the treatment and before people return to the space.

## 4. Scope

Where?

- Home & Kitchen
- Offices & Stores
- Cars & Boats
- Hotels & Restaurants
- Hospitals & Clinics
- Attics & Basements
- Bars

Against what?

- Pet Odors
- Cooking Odors
- Musty Smell
- Smoking Smell
- Chemical Odors (Formaldehyde)
- Virus
- Bacteria

## 5. Storage

If you are not going to use the product for an extended period of time, unplug it from the electrical outlet, clean it and store it in a cool and dry place away from direct sunlight.

## FREQUENT ASKED QUESTIONS

---

**Q: What is Ozone**

A: Ozone exists in the ozone layer region of the atmosphere to protect human beings from the sun's ultraviolet radiation. We also sense its fresh and clean smell after thunderstorms. Now we have Airthereal Ozone Generators to move this nature's powerful sterilizer into your house. Ozone ( $O_3$ ) contains three atoms of oxygen. The third oxygen atom makes ozone extremely reactive, which readily attaches itself to other molecules. When odors, bacteria or viruses meet ozone, oxidation reactions occur and both parties are destroyed. Ozone essentially reverts back to oxygen. That's why it's environment friendly.

**Q: Ozone Air Purifier VS Air Filters**

A: Air filters are normally the result of a physical process with air. However, ozone air purifiers produce activated oxygen that removes odors and freshens the air.

**Q: Safety Concerns**

A: High ozone concentration can be irritating to mucous membranes and the respiratory system. The right level is when all the generated ozone is being consumed. This only applies to continuous ozone use in occupied environments not for shock treating. With ozone, more is not considered better. Ozone can work even when humans are not able to smell it.

**Q: How Ozone Air Purifiers work**

A: Ozone generators create ozone using mechanisms such as an ultraviolet light or a corona discharge (a type of electrical discharge). The machine is also equipped with a fan that disperses the ozone out into the air. In theory, these ozone particles will come into contact with indoor air pollution and neutralize them — for instance, by killing living pollutants such as bacteria.

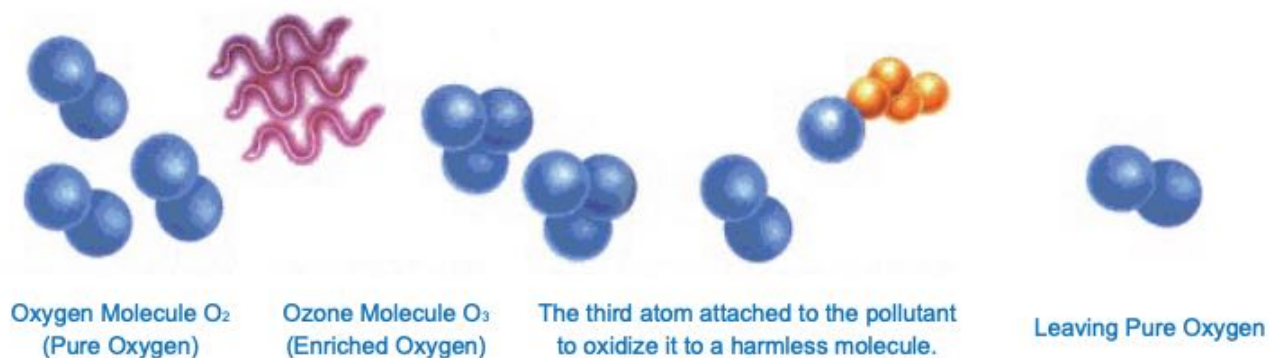
**Q: How Long Does Ozone Last**

A: As soon as ozone is formed in the generator and dispersed in a room, some of it reverts back into oxygen. Ozone itself has a half-life, which means that “residual” ozone created (extra ozone) will return to oxygen usually within 30 minutes, in amounts equal to half its level. What this means is that after each subsequent 30 minute period there would be half as much residual ozone left at the end of the period as was present at the beginning of the



period. In practice the half-life is usually less than 30 minutes due to temperature, dust, and other contaminants in the air. Therefore, ozone, while very powerful, doesn't last long. It does its job and then disappears.

## TROUBLE SHOOTING

---

If you suspect a problem with your unit, check the following:

- Unit is plugged in properly and turned on.
- Wall outlet is effective.
- Clean or change the ozone plates as follows if the ozone output is weak. Environmental factors affect the duration of ozone output. Unscrew the four screws on both sides of the machine. Press the handle, loosen the ozone holder, and draw out the ozone plate, clean it with water or replace with a new one, make sure the plate is dry and the metal terminals contact well.

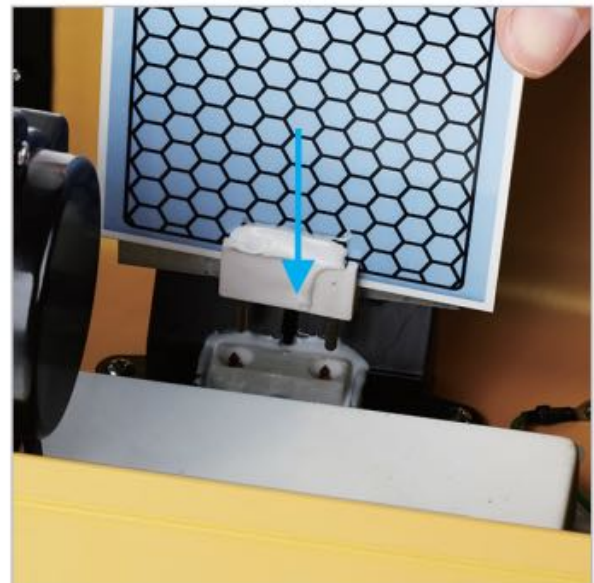
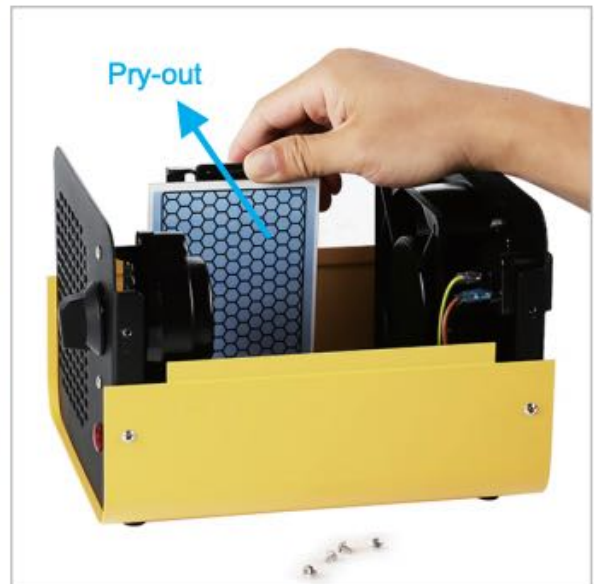

- Check the fuse to make sure it is installed properly and not burned out. To replace fuse, push in and turn fuse holder to the left with straight screwdriver, remove old fuse, replace with spare (spare fuse is inside the fuse holder). Use 4 amp fuse, 1.25 inches long.



- For optimal use, please clean the pre-filter once every 6 months.



- It's important that the ozone generator is properly grounded to avoid potential shock.

Caution:

Power off before you unscrew the unit and insert ozone plate or replace parts.

## **SERVICE AND CONTACT**

[www.airthereal.com](http://www.airthereal.com)

Email: [support@airthereal.com](mailto:support@airthereal.com)

Address: 6140 North Hollywood Boulevard, Suite 110, Las Vegas, Nevada 89115 USA

Please feel free to contact us for support and service.

Your requirement will be addressed within 24hrs.

V 20200421



## Documents / Resources

---

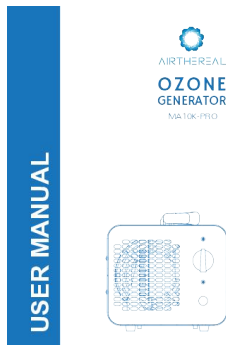

[AIRTHEREAL Ozone Generator \[pdf\] User Manual](#)  
 Ozone Generator, Ma10k-Pro

## References

---

ADVERTISING

## Related Manuals / Resources

---

- [Craftsman Inverter Generator CMXGIAC3000 User Manual](#)  
 Craftsman Inverter Generator CMXGIAC3000 User Manual - Original PDF
- [gigKAT 2 TOne Generator User Manual](#)  
 gigKAT 2 TOne Generator
- [8750W Portable Inverter Generator User Manual](#)  
 8750W Portable Inverter Generator User Manual - Optimized PDF 8750W Portable Inverter Generator User Manual - Original PDF
- [Westinghouse WGen6000 Portable Generator User Manual](#)  
 Westinghouse WGen6000 Portable Generator User Manual - Optimized PDF Westinghouse WGen6000 Portable Generator User Manual - Original PDF



